

AQUARION[®]

**INSTALLATION • OPERATION • MAINTENANCE MANUAL
SELF-CONTAINED EYEWASH STATION**

AQ100H130 PRODUCT DESCRIPTION
Self-contained Emergency Eyewash Station designed to provide a 15-minute eyewash flush without external force. Unit will offer freeze protection when supplied with power and properly wall mounted.



Component Part Number	Component Description	Qty
01130400	Rear Mounting Bracket	1
AQ120S AQ110	Eyewash Cartridge Sterilized Eyewash Cartridge (Available only in Canada)	2 (SOLD SEPARATELY)

1.0 ASSEMBLY AND INSTALLATION INSTRUCTIONS

Step 1. Rear Mounting Bracket (Ref Figure 1)

Note: Bottom of bracket should be 45" to 52" from standing level

- A. Rear Mounting Bracket attaches to wall through two openings in Lower Insulated Jacket. The web on the back side Lower Insulated Jacket must be centered and sit flat in the channel on the back of the bracket and wall.
- B. **Wall Mounting:** Use four (4) Primary Mounting Holes. Hardware (supplied by others) to be 1/4" shall be 1/4" diameter and of suitable type for surface unit is to be mounted on. **Note: Mounting hardware supplied by others.**

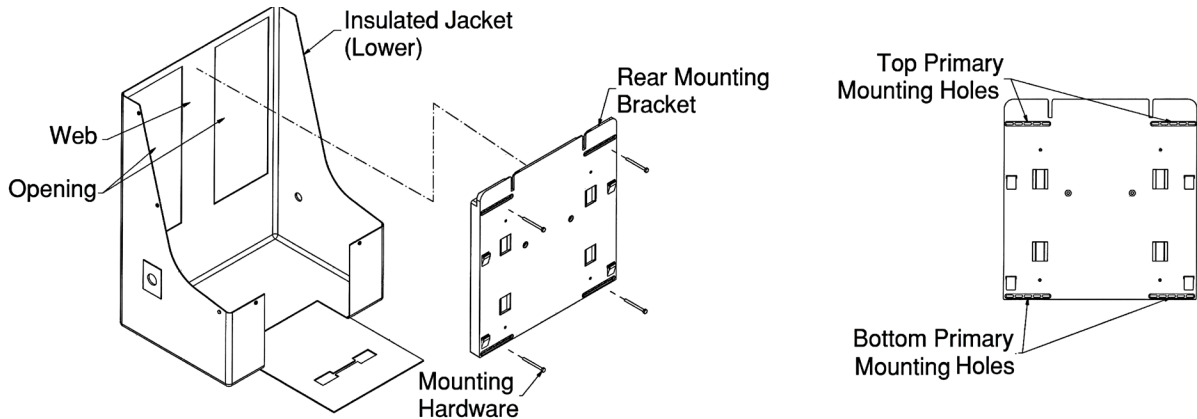

FIGURE 1

Step 2. Housing Assembly (Ref Figure 2)

- A. Place Housing Assembly on Rear Mounting Bracket utilizing Mounting Tabs and holes in rear of housing.
- B. Route Power Input through corresponding access port in Lower Insulated Jacket (**Ref "A"**)
- C. Secure Housing using Thread Forming Screw (4) provided. This step is **optional** intended for high vibration applications.

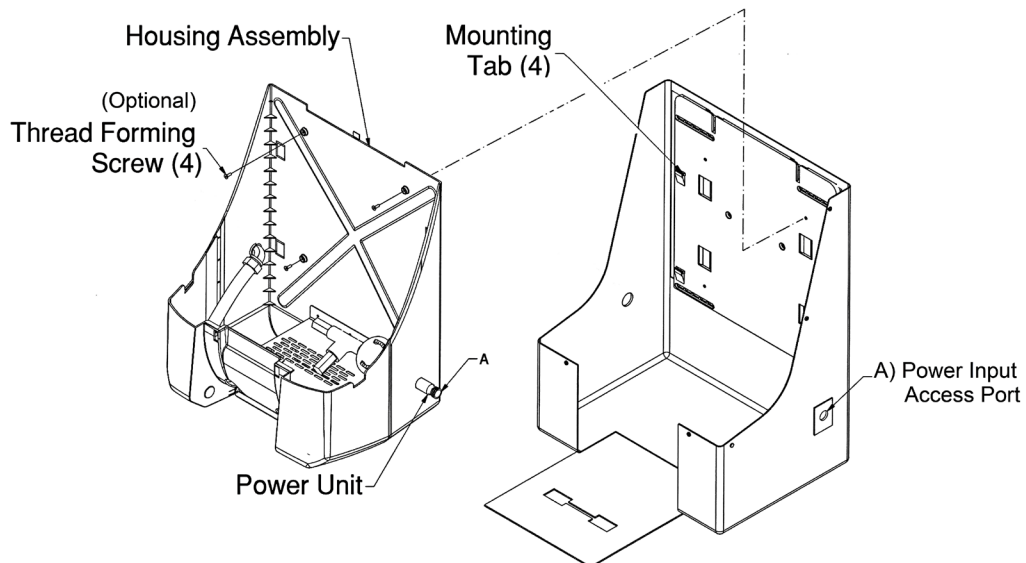

FIGURE 2

1.0 ASSEMBLY AND INSTALLATION INSTRUCTIONS

Step 3. Hanger Brackets (Ref Figure 3)

- A. Insert Hanger Brackets in slots on Rear Mounting Bracket, 2 places, as shown.

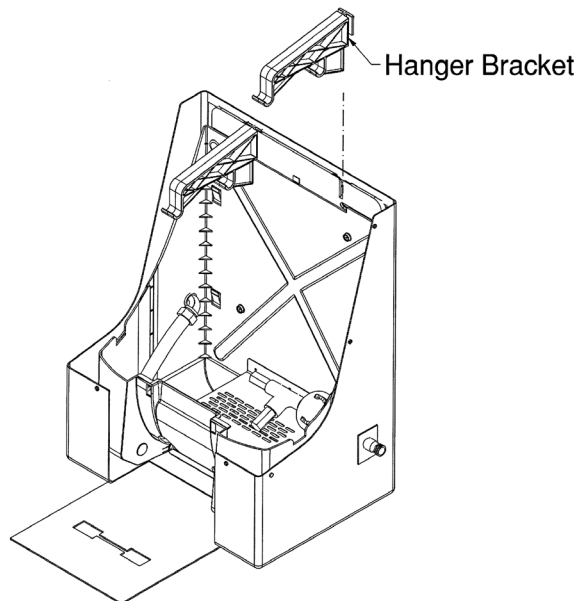

FIGURE 3

Step 4. Tray Assembly (Ref Figure 4)

- A. With Tray Assembly in horizontal position and tray flap of jacket (**not shown**) moved out of the way, insert Pivot Post fully into Pivot Socket one side, then the other. Tray Assembly should swing freely if post is fully engaged
- B. The tray should not be removed without the optional tray removal tool from Encon.

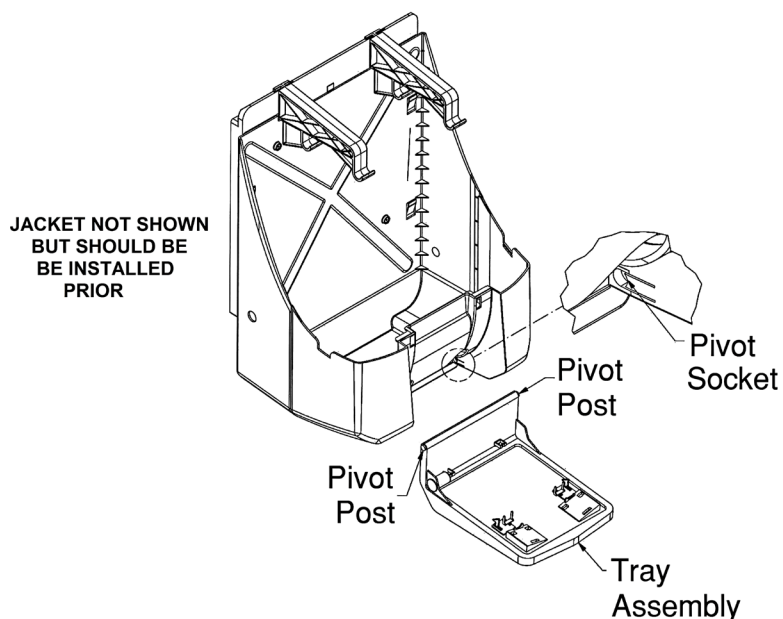

FIGURE 4

1.0 ASSEMBLY AND INSTALLATION INSTRUCTIONS

Step 5. Power Connection (Figure 5)

WARNING STATEMENT: The area where this Heated Eyewash is to be used should be evaluated for electrical classification hazard potential. The attachment plug was purposely not supplied with the unit. The installer must supply the appropriate 3-pronged male plug or other connection as may be required as acceptable to local electrical codes and authorities.

WARNING WARNING WARNING
TO PREVENT A SHOCK HAZARD, USE ONLY WITH A GROUND FAULT CIRCUIT INTERRUPTER.

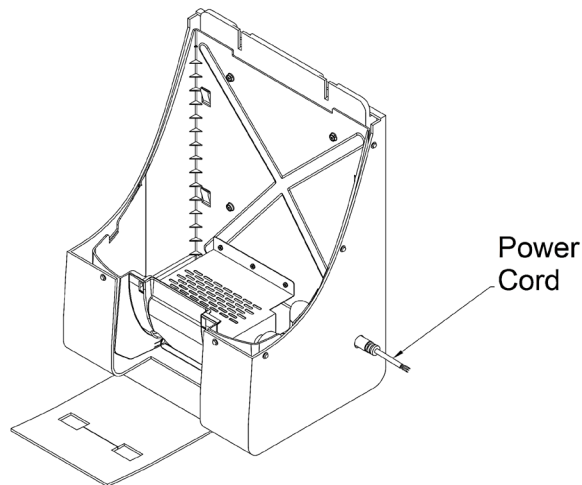

FIGURE 5

Step 6. Load Fluid Cartridges

- A. Lift first Cartridge by handle provided and place on rear hooks of Hanger bracket (**Ref Figure 6**).
Caution: weight is approximately 31 lbs (14kg)
- B. Lift second Cartridge by handles provided and place on front hooks of hanger bracket (**Ref Figure 7**).

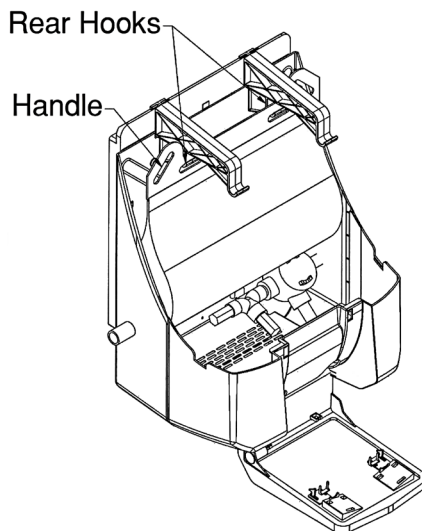

FIGURE 6

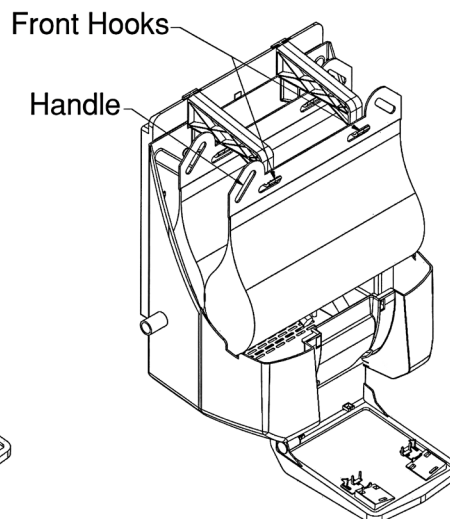

FIGURE 7

1.0 ASSEMBLY AND INSTALLATION INSTRUCTIONS

Step 7. Nozzle installation

- A. With Lid Assembly removed and Tray Assembly in the open position, feed the first Nozzle Assembly (part of Fluid Cartridge Assembly) through the Access Port on the Housing Assembly. **(Ref Figure 8)**
- B. To ensure that there is no tension on the tubing, verify that the tubing is captured in the tube clamps and curved slightly inward between the tube clamps and the tray forks. **(Ref Figure 9).**

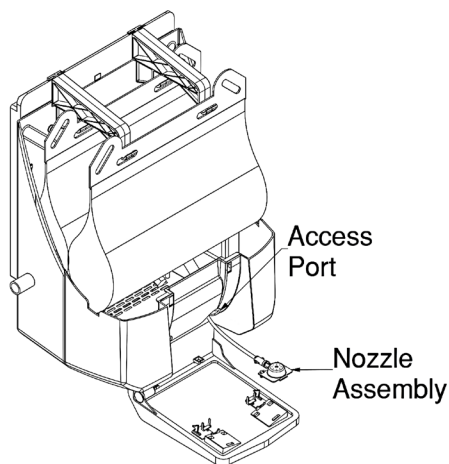

FIGURE 8

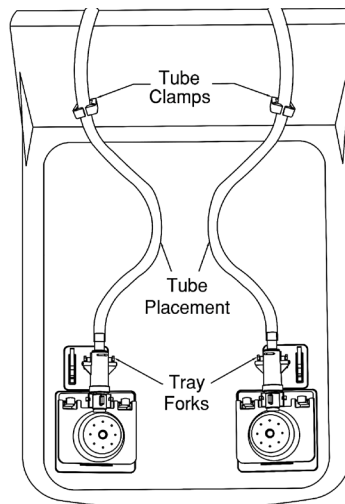

FIGURE 9

- C. After securing the Cartridge tube within the Tube Clamp, verify the notch of both left and right connector 2's are orientated on the right-hand side of the nozzle assembly **(Figure 10)**. If the notch of connector 2 is not on the right side of both eyewash heads perform the following steps:
 1. Disconnect the hose assembly from the eyewash head.
 2. Remove Connector 2 from the hose assembly.
 3. Rotate Connector 2 by 180 degrees.
 4. Reattach Connector 2 to the hose assembly.
 5. Reconnect the hose assembly to the eyewash head.

WARNING: FAILURE TO PROPERLY ORIENTATE CONNECTOR 2 MAY CAUSE A DISRUPTION OR BLOCKAGE OF FLOW FROM THE CARTRIDGE.

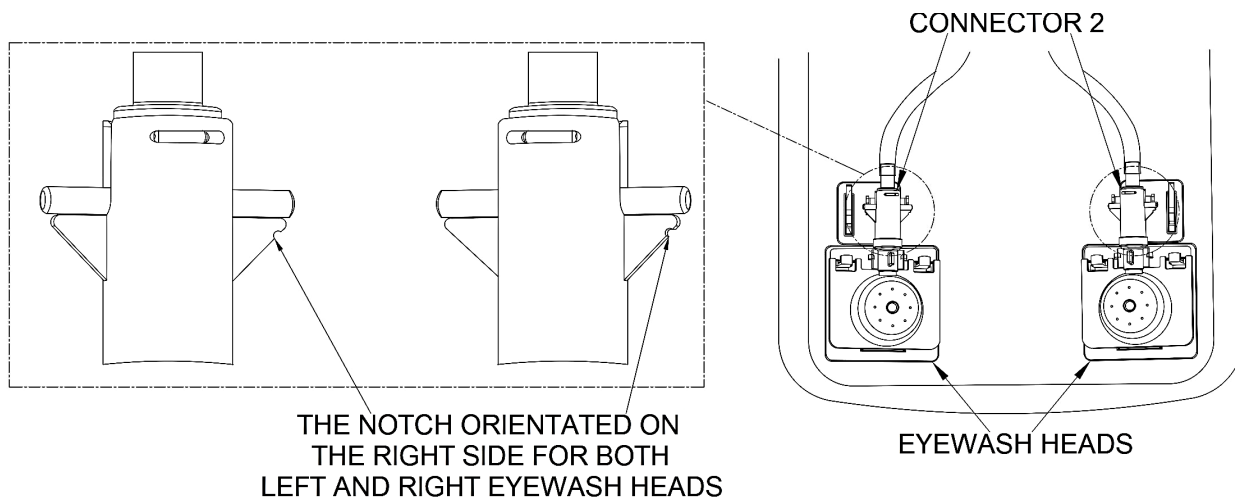

FIGURE 10

1.0 ASSEMBLY AND INSTALLATION INSTRUCTIONS

- D. Tilt Nozzle Assembly to insert alignment lip into guide slot on Tray Assembly (**Ref Figure 11**)
- E. Insert Snap Locks on Nozzle Assembly in to mating slots on Tray Assembly. **NOTE:** Both locks must fully engage with slots. During installation, the Safety Collar will snap off the assembly. This collar can be discarded or set aside. It should not be re-installed unless cartridge is removed for external transportation.
- F. Repeat Step C-F for opposite side.

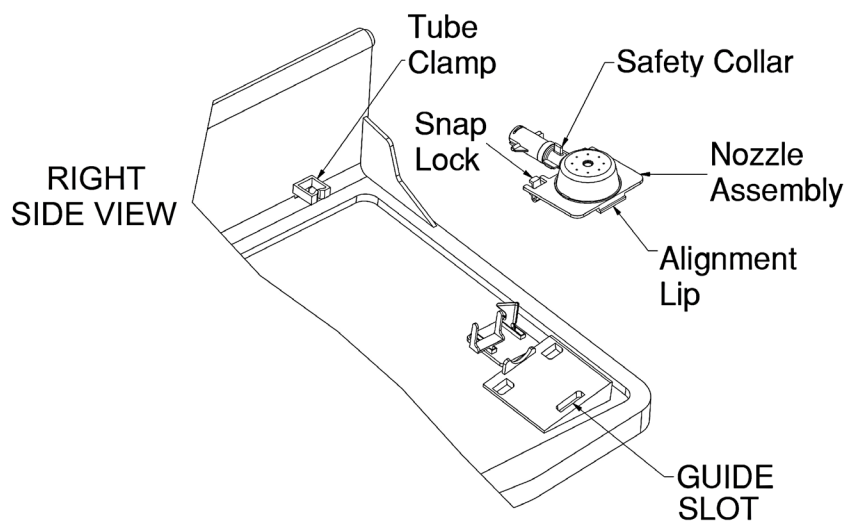

FIGURE 11

Step 8. Lid Assembly (Ref Figure 11)

- A. Install by putting outward pressure on lid bottom while setting it onto housing assembly. Tabs on both sides should “snap” into place at alignment slot inside housing assembly (**Figure 12**).

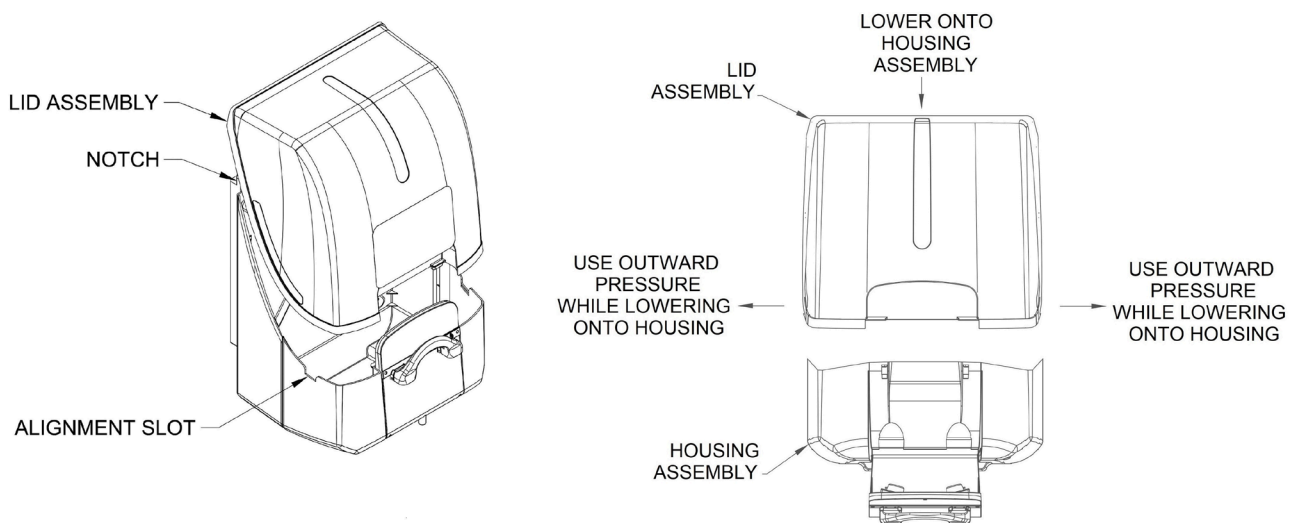

FIGURE 12

1.0 ASSEMBLY AND INSTALLATION INSTRUCTIONS

Step 9. Closing unit

- A. With lid assembly installed and tray closed, place easy Break Away Tag through hole provide on right side of handle (**Ref Figure 13**)

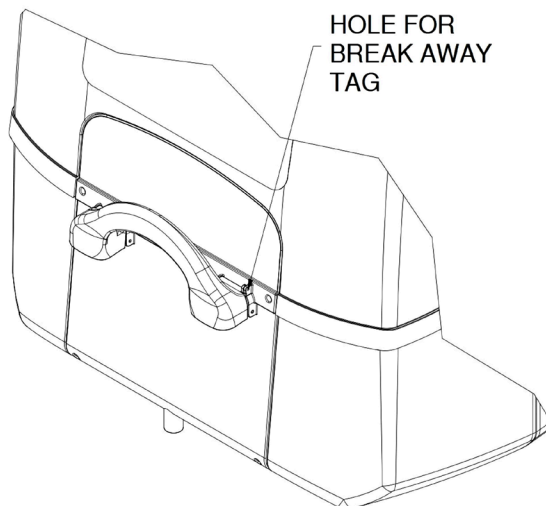

FIGURE 13

Step 10. Upper Insulated Jacket (Ref Figure 14)

- A. Secure Upper Insulated Jacket to Lower Insulated Jacket utilizing snaps (8 places).
B. Place handle of Tray Assembly through provided notch in Front Flap, part of Lower Insulated Jacket.
C. Top edge of Front Flap must be positioned under Protective Flap, part of Upper Insulated Jacket.

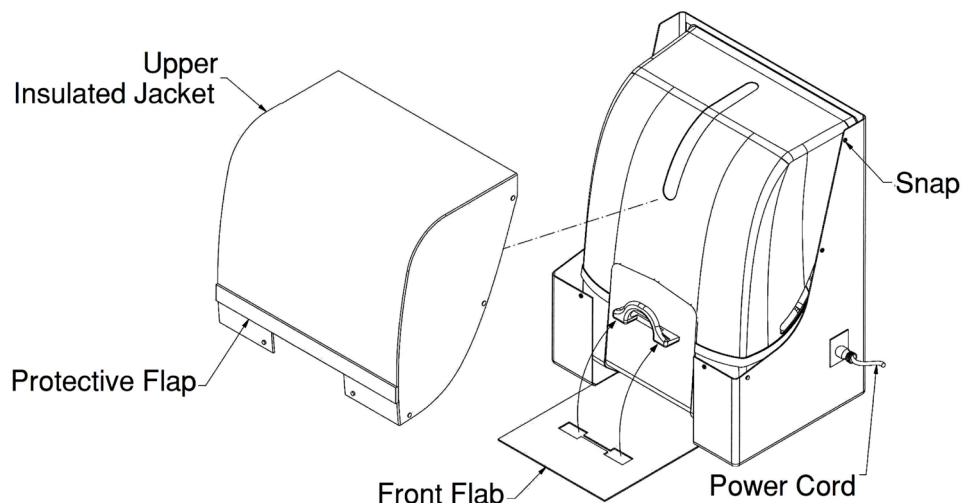

FIGURE 14

2.0 OPERATION

- A. **Note: Once activated flow cannot be stopped and cartridge must be replaced.**
To operate the unit, pull down firmly on the tray handle. The Tray Assembly will swing forward into an open position. Once opened, it will pierce the Fluid Cartridge Hose Connector, thus starting the 15 minutes of flow. To open the tray without activating it, see maintenance step 3.
Note: Once activated flow cannot be stopped and cartridge must be replaced.

3.0 MAINTENANCE

Step 1. Primary Inspection

- A. Visually inspect Cartridge status through Side Windows on Lid Assembly (Ref Figure 15).
- B. Visually inspect easy Break Security Tag is intact (Ref Figure 13).

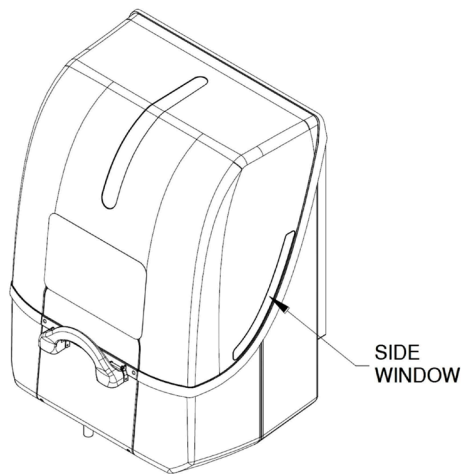

FIGURE 15

Step 2. Interior Inspection

- A. To inspect the interior of the unit, remove the Lid Assembly. A slight pressure must be applied to both sides of the Lid to remove This will disengage the Locking Tab inside lid assembly. While pressing, lift upward and cover will come off (Ref Figure 17).

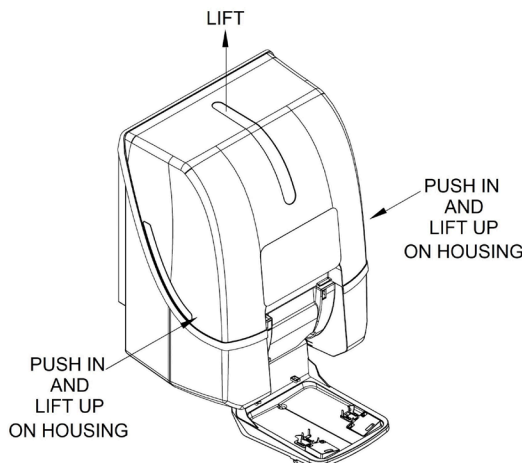

FIGURE 16

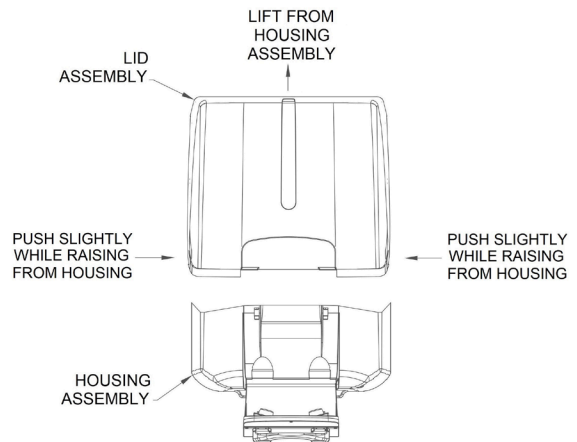

FIGURE 17

3.0 MAINTENANCE

Step 3. Opening Unit (without piercing fluid cartridge hose connector seals)

- A. To inspect the interior of unit, remove Lid Assembly ref. **Step 2**.
- B. To inspect Tray Assembly utilizing Supervisory Override Latch. Override Latches are located on underside of handle (**Ref Figure 18**). Both latches must be depressed to allow tray to open.
Note: The only way to open Tray Assembly without breaking easy Break Security Tag and activating Fluid Cartridge is to use the override latch.

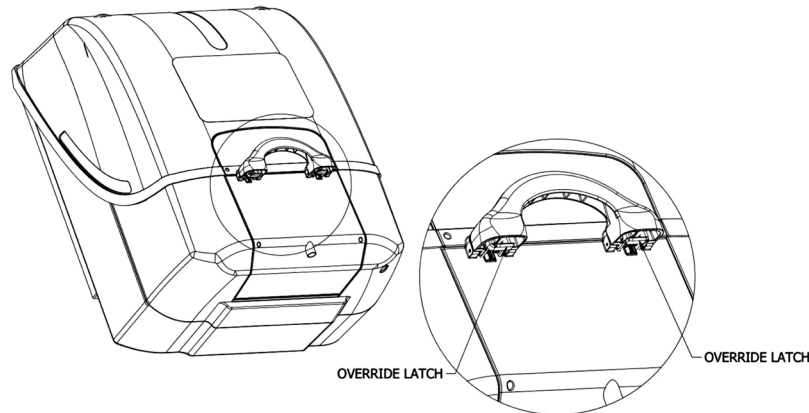

FIGURE 18

Step 4. Tray Assembly Inspection

- A. With the tray open, carefully remove nozzle assembly (**Ref. Step 7-D**) and inspect area, including tray forks and tray handle locks (**Ref. Figure 19**) for any deformities or corrosion.
NOTE: Caution should be exercised when removing nozzle assembly for risk of breaking seal on fluid cartridge.
- B. With the tray open and nozzles removed, Function test tray handle lock/latch by pressing the override lock/latch (**Ref Figure 18**), and operating the locks, tray handle lock/latches should move back and forth smoothly in their slots (**Ref Figure 19**).
- C. Function test Tray assembly by lifting tray up and down without fully closing the tray. Tray assembly should move freely up and down smoothly without any restriction.

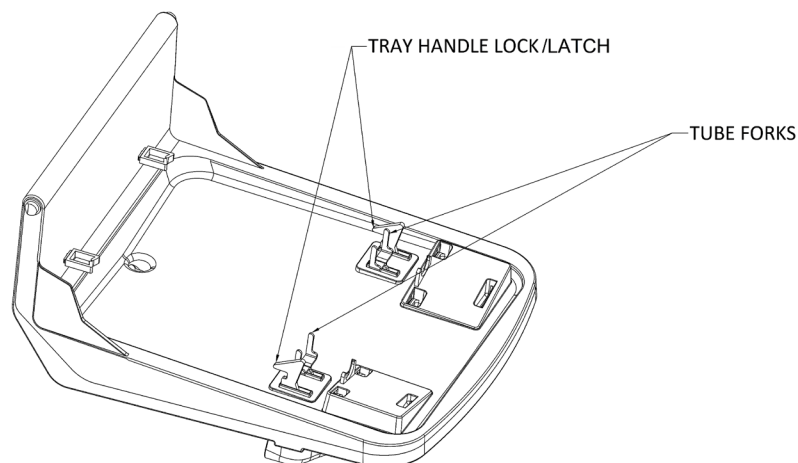

FIGURE 19

4.0 TRAINING

All employees who might be exposed to hazardous material shall be instructed in the location and proper use of emergency shower and eye/facewash units. Experiences have shown that initial first-aid treatment for irritates should be to wash the eyes and face for 15 minutes prior to medical treatment. It is important to hold the eyelids open and roll the eyes so water will flow on all surfaces and in the folds surrounding the eyes.

PROPOSITION 65

WARNING: This product can expose you to BPA, which is known to the State of California to cause birth defects or other reproductive harm. For more information go to www.P65Warnings.ca.gov.

5.0 WARRANTY STATEMENT

ENCON HEREBY DISCLAIMS ALL WARRANTIES EXPRESSED OR IMPLIED INCLUDING BUT NOT LIMITED TO WARRANTIES OF MERCHANTABILITY, FITNESS FOR A PARTICULAR PURPOSE, AND NON-INFRINGEMENT OF THIRD-PARTY RIGHTS, EXCEPT AS HEREINAFTER PROVIDED.

Encon Safety Products warrants that for one year from the date of purchase of any Encon products, the product will be free of defects in materials and workmanship if properly used and cared for or cleaned under normal conditions in accordance with Encon's use and care instructions and properly installed, if applicable, in accordance with Encon's installation instructions. With respect to the product, Encon's only obligation and purchaser's exclusive remedy under this warranty is to repair or replace such product; provided that:

- 1. Encon is notified of the defect within one year of shipment, and**
- 2. the product is determined by Encon to be defective.**

Encon requires proof of original ownership as proof of warranty coverage, and Encon must receive any claim under this Limited Warranty within one year of purchase of the product.

NOTWITHSTANDING ANYTHING TO THE CONTRARY CONTAINED HEREIN, ENCON SHALL NOT BE LIABLE FOR LOSS, DAMAGE, OR EXPENSE ARISING DIRECTLY OR INDIRECTLY AS A CONSEQUENCE OF USE OF THE EQUIPMENT WITH OTHER PRODUCTS OR FROM ANY OTHER CAUSE, INCLUDING ANY CONSEQUENTIAL, INCIDENTAL, SPECIAL OR EXEMPLARY DAMAGES, EXCEPT FOR ENCON'S OBLIGATION TO REPAIR OR REPLACE DEFECTIVE PRODUCTS AS EXPRESSLY PROVIDED IN THIS STATEMENT.

Replacement parts purchased from Encon are warranted for one year following the shipment of such replacement part, or until the expiration of the warranty period for the product, whichever is less. No warranty is given in connection with products that are altered without Encon's expressed written consent. The same warranty limitations and the obligations of Encon as set out herein above shall apply to replacement parts.

Encon's total liability arising out of this warranty (including, but not limited to, warranty claims) regardless of forum and regardless of whether such action or claim is based on tort, contract or otherwise will not exceed the total purchase price of the product.